

**TYPE No. 1**  
150mm - 450mm DIA. (INCL.) DROP GREATER THAN 1700mm  
500mm - 900mm DIA. (INCL.) DROP GREATER THAN 2300mm

1. ALL DIMENSIONS ARE IN MILLIMETRES (mm) UNLESS NOTED OTHERWISE.
2. RODDING EYE CHAMBER SHALL BE COVERED WITH APPROVED HEAVY DUTY METAL COVERS TO IS 261 AND BS 5834. COVER AND FRAME SHALL BE SUITABLE FOR ROAD AND TRAFFIC CONDITIONS AND IS SUBJECT TO REVIEW BY IRISH WATER.
3. ALL CHAMBERS TO BE CHECKED FOR UPLIFT BY THE DEVELOPER BASED ON GROUND CONDITIONS WITHIN THE SITE. SHOULD ANTI-FLOATATION MEASURES BE REQUIRED THEY SHALL BE SUBJECT TO REVIEW BY IRISH WATER.
4. ALL CONCRETE TO BE IN ACCORDANCE WITH IS EN 206.
5. MANHOLE DETAILS TO BE IN ACCORDANCE WITH STD-WW-09, 10 AND 11

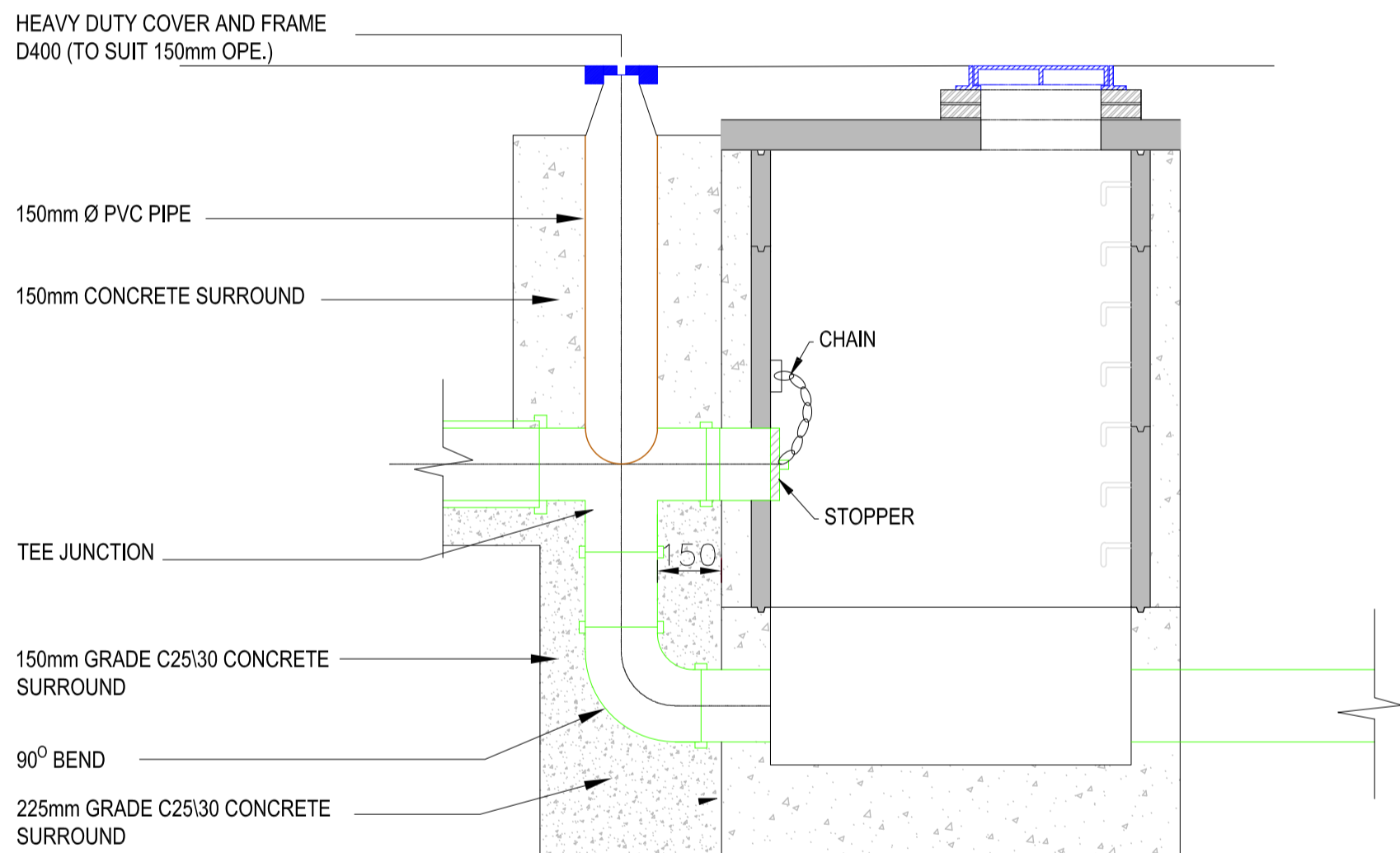

**TYPE No. 2**  
150mm - 450mm DIA. (INCL.) DROP GREATER THAN 900 AND LESS THAN 1700mm  
500mm - 900mm DIA. (INCL.) DROP GREATER THAN 1300mm AND LESS THAN 2300mm

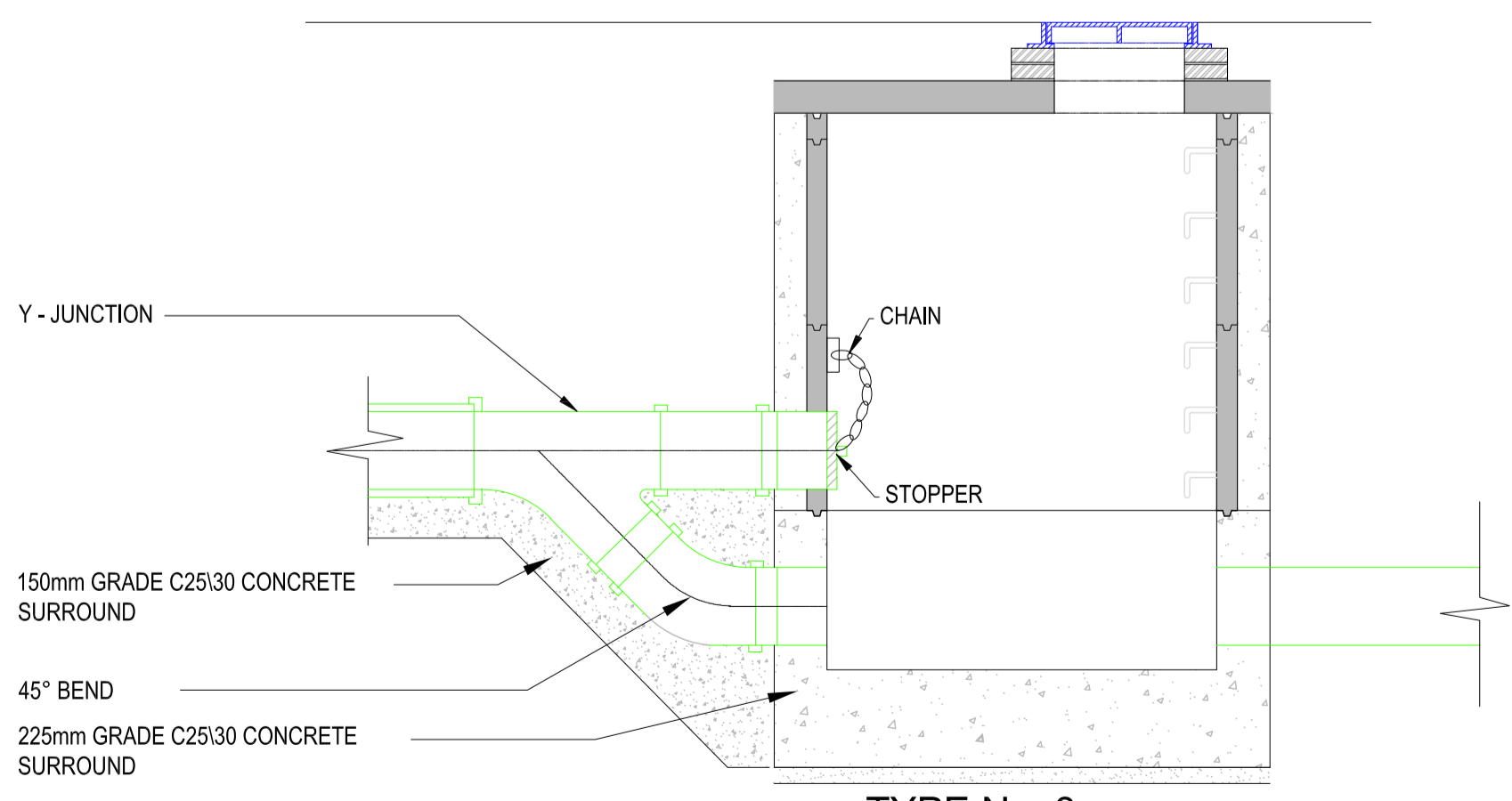

**TYPE No. 3**  
150mm - 450mm DIA. (INCL.) DROP GREATER THAN 600mm AND LESS THAN 900mm  
500mm - 900mm DIA. (INCL.) DROP GREATER THAN 600mm AND LESS THAN 1300mm

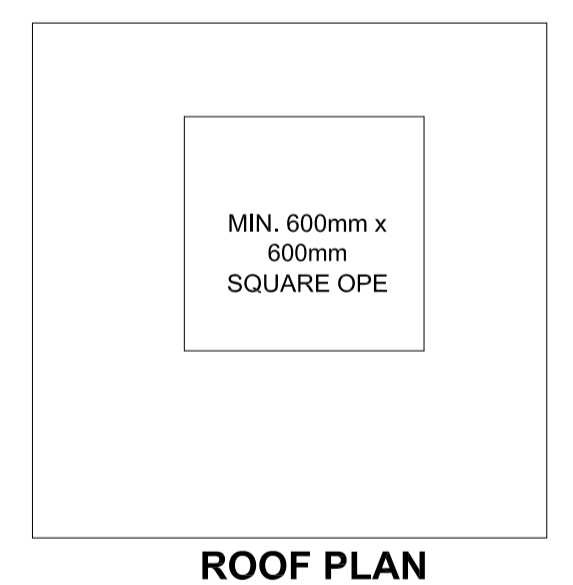
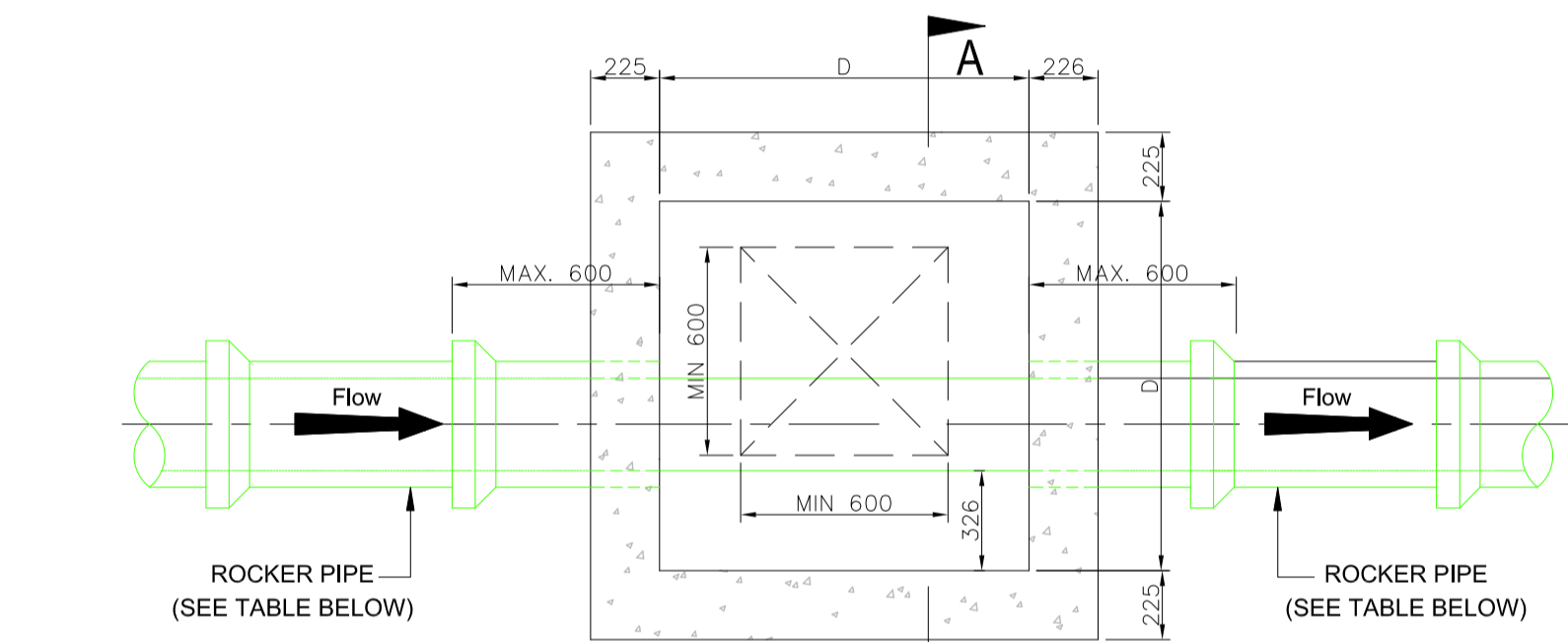
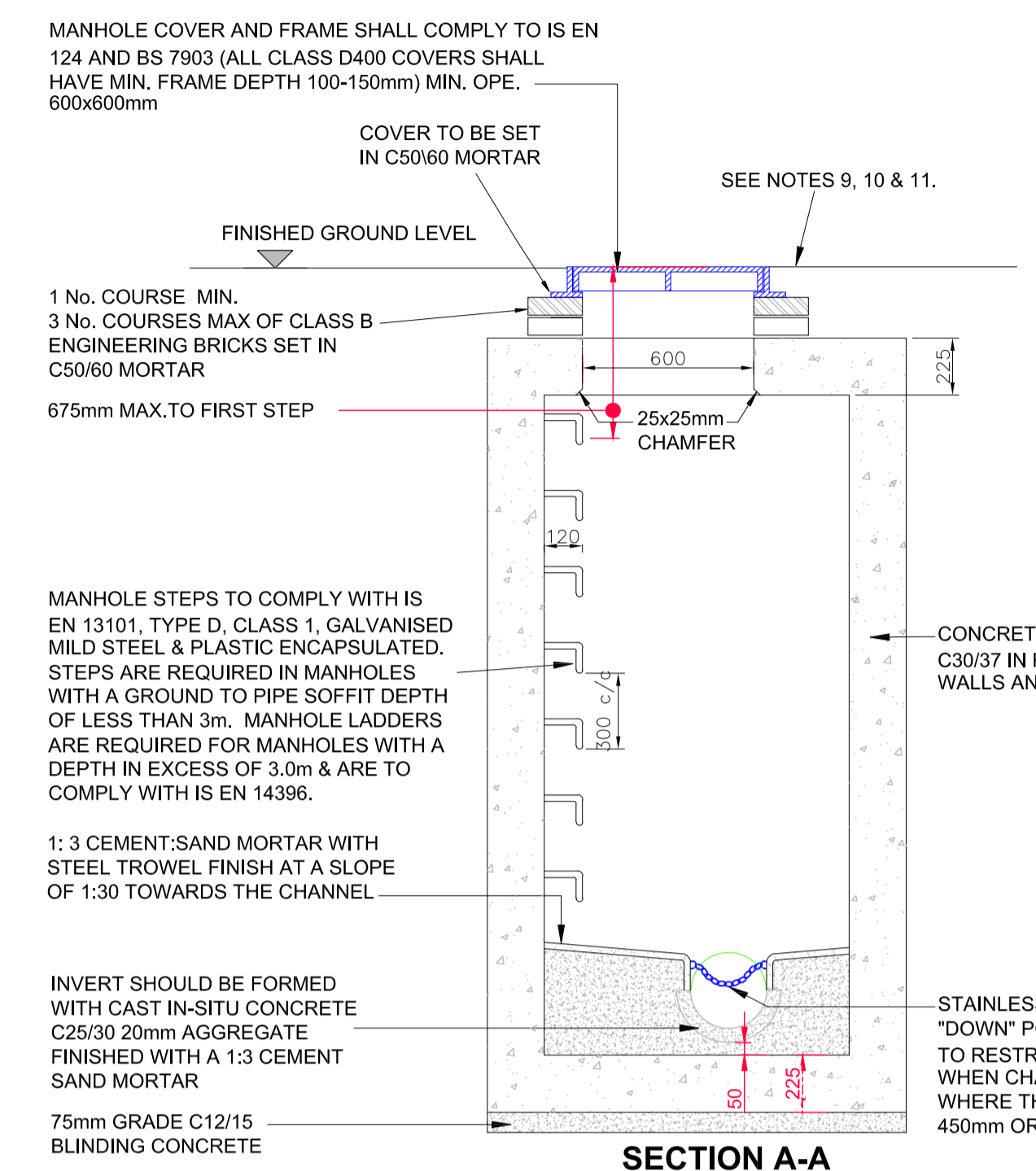

ROCKER PIPE LENGTH	
PIPE DIAMETER (mm)	ROCKER PIPE LENGTH (mm)
150 TO 600	600
GREATER THAN 600 TO 750	1000
GREATER THAN 750	1250

MINIMUM MANHOLE DIMENSION "D"	
DIAMETER OF LARGEST PIPE IN MANHOLE (mm)	INTERNAL DIMENSION OF MANHOLE (mm)
LESS THAN 375	1200
375 TO 450	1350
500 TO 750	1500

1. ALL DIMENSIONS ARE IN MILLIMETRES (mm) UNLESS NOTED OTHERWISE.
2. IN-SITU MANHOLES TO HAVE A MINIMUM WALL AND FLOOR THICKNESS OF 225mm FOR MANHOLE DEPTHS UP TO 3.0m AND 300mm OR MORE WHEN THE MANHOLE DEPTH EXCEEDS 3.0m.
3. STRUCTURAL DESIGN & REINFORCEMENT DETAILS TO BE PROVIDED BY THE DEVELOPER AND SUBMITTED TO IRISH WATER FOR REVIEW. MANHOLE ROOFS SHALL CONSIST OF A REINFORCED CONCRETE SLAB OF IN-SITU CONCRETE, C30/37, WITH A MINIMUM THICKNESS OF 225mm DESIGNED TO CARRY ALL LIVE AND DEAD LOADS. ALTERNATIVELY, APPROVED PRE-CAST CONCRETE ROOF SLABS MAY BE USED SUBJECT TO IRISH WATER APPROVAL AND COMPLIANCE WITH BS 5911 PART 4: 2002.
4. MANHOLES GREATER THAN 3m IN DEPTH WILL REQUIRE A DETAILED STRUCTURAL DESIGN AND BE SUBJECT TO IRISH WATER REVIEW.
5. COVERS AND FRAMES SHALL BE SUITABLE FOR ROAD AND TRAFFIC CONDITIONS SUBJECT TO REVIEW BY IRISH WATER.
6. 200mm ALL AROUND, 100mm DEEP CONCRETE PLINTH AROUND COVERS IN GREEN AREAS.
7. ALL CHAMBERS TO BE CHECKED FOR UPLIFT BY THE DEVELOPER BASED ON GROUND CONDITIONS WITHIN THE SITE. SHOULD ANTI-FLOATATION MEASURES BE REQUIRED THEY SHALL BE SUBJECT TO REVIEW BY IRISH WATER.
8. ALL CONCRETE TO BE IN ACCORDANCE WITH IS EN 206 : 2013.
9. ANY SPECIAL ROAD REINSTATEMENT AROUND COVER & FRAME SHALL BE TO ROAD AUTHORITY'S REQUIREMENTS.
10. NEW ROAD CONSTRUCTION & SURFACE FINISH TO BE TO ROAD AUTHORITY REQUIREMENTS.
11. EXISTING ROAD REINSTATEMENT TO COMPLY WITH CURRENT VERSION OF "GUIDELINES FOR MANAGING OPENINGS IN PUBLIC ROADS" BY THE DEPT. OF TRANSPORT, TOURISM & SPORT, OR TRANSPORT INFRASTRUCTURE IRELAND REQUIREMENTS.
12. IF DEPTH FROM GROUND TO PIPE SOFFIT EXCEEDS 6m, A SITE SPECIFIC ENGINEERED SOLUTION FOR ACCESS SHALL BE PROVIDED.

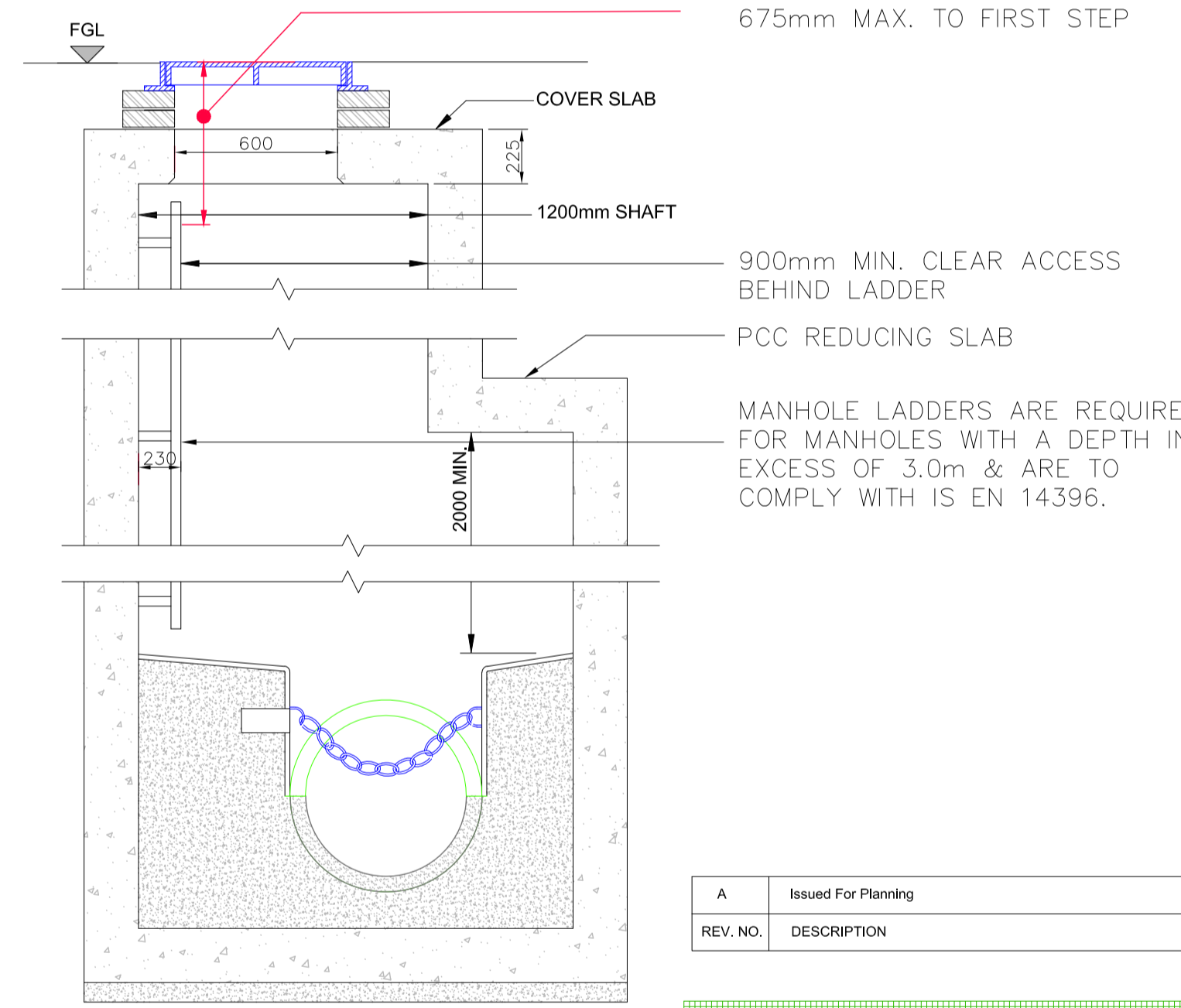

**MANHOLE DETAIL > 3m & < 6m**  
**GROUND TO PIPE SOFFIT DEPTH**  
(NOTE: ON MANHOLES <1.5m SHAFT DIMENSION, REDUCING SLAB NOT TO BE USED & SHAFT TO CONTINUE UP TO COVER SLAB)

REV. NO.	DESCRIPTION	DATE	INITIALS
A	Issued For Planning	May 2019	T.Finn

**flinn** PARTNERSHIP CREATIVE • INNOVATIVE

DESIGN PARTNERSHIP

Blakestown, Ardee, Co. Louth, Ireland  
t 041 6857200 f 041 6857201 e info@flinn.ie www.flinn.ie

DRAWING NO: **145** REV. NO: **A**

TITLE: **Foul Drainage Details (Sheet 3 of 3)**

PROJECT: Residential Development @ Haggardstown Blackrock, Dundalk Co Louth.

CLIENT: Kingsbridge Consultancy Ltd  
1st Floor, Block 1, Quayside Business Park, Dundalk Co Louth

SCALE: As Shown DRAWN: T.Finn  
DATE: November 2018 CHECKED: Details

STATUS: **Planning Permission**

JOB NO: **1703**

NOTES  
1. Copyright Reserved 2013 ©  
2. Work is issued dimension only. Do not scale drawings.  
3. The contractor is responsible for checking all levels and dimensions on site and shall refer all discrepancies to the Architect.  
4. Where responsible for details of civil, structure or mechanical and electrical details, see Engineers drawings.  
5. Proprietary items shall be fixed in strict accordance with manufacturers instructions.  
6. Sizes of proprietary items shall be checked with manufacturers.  
7. The contractor shall be responsible for the coordination of structure frames and services.